



Ground Floor



Entrance Porch

Enter via a uPVC/partly double-glazed front door and having two obscured uPVC/double glazed windows one to the front aspect and one to the side aspect, wall lighting, tiled flooring and a glazed door opening to the hallway.

Hallway

Having a coved ceiling, wall lighting, a central heating radiator, tiled flooring, decorative dado railing, a double door storage cupboard, glazed doors to the lounge and the kitchen and doors to bedroom one, bedroom two and the shower room.

Lounge

24' 6" x 17' 6" (7.46m x 5.33m)

Having a coved ceiling with two ceiling light points, wall lighting, a central heating radiator, a wood burner, vinyl flooring, a carpeted spindle stairway leading to the first floor, double glazed doors opening to the dining room and uPVC/double glazed French doors to the rear aspect opening to the garden with uPVC/double glazed full height windows each side.

Dining Room

16' 0" x 8' 4" (4.87m x 2.54m)

Being open plan to the kitchen and having a uPVC/double glazed window to the side aspect, a coved ceiling with a ceiling light point, wall lighting, a central heating radiator and tiled flooring.

Kitchen

16' 1" x 11' 0" (4.90m x 3.35m)

Being open plan to the dining room and being fitted with a range of wall, base and drawer units with laminate worksurface over and having a uPVC/double glazed window to the rear aspect fitted with Roman blinds, two ceiling light points, under cabinet accent lighting, the central heating combination boiler, a double bowl stainless steel sink with a spray arm mixer tap fitted and a drainer unit, tiled splashbacks, an electric range oven/hob with a chimney style extraction unit over, a space for an upright fridge/freezer, plumbing for a washing machine, space for a tumble dryer, tiled flooring and a door to the side aspect opening to the garage.

Bedroom One

12' 10" x 11' 5" (3.91m x 3.48m)

Having a uPVC/double glazed bow window to the front aspect, a coved ceiling with a ceiling light point, a central heating radiator and carpeted flooring.

Bedroom Two

11' 11" x 10' 11" (3.63m x 3.32m)

Having a uPVC/double glazed bow window to the front aspect, a ceiling light point, a central heating radiator and a sliding door opening to the en-suite wet room.

En-suite Wet Room

Having an obscured uPVC/double glazed window to the front aspect, a WC, a wash hand basin, a ceiling light point, an extraction unit, a central heating radiator, vinyl flooring, partly tiled walls and an electric shower.

Shower Room

Having an obscured uPVC/double glazed window to the side aspect with a roller blind fitted, a ceiling light point, a chrome-finished central heating towel rail, a WC, a wash hand basin with a mixer tap fitted and under-sink storage, fully tiled walls, vinyl flooring and a walk-in shower with a thermostatic shower installed.



First Floor

Landing

Having a ceiling light point, carpeted flooring and a door to the bedroom three.

Bedroom Three

13' 8" x 13' 4" (4.16m x 4.06m)

Having two uPVC/double glazed bow windows one to the front aspect and one to the rear aspect, a ceiling light point, a central heating radiator with a decorative cover fitted, carpeted flooring, a door to the en-suite WC and a range of fitted bedroom furniture which include: wardrobes, a dressing table, drawers and shelving.

En-suite WC

Having a WC, a wash-hand basin, wall lighting, carpeted flooring and eaves storage.

Outside

Garage

37' 8" x 11' 4" (11.47m x 3.45m)

Having power, lighting, double doors opening to the driveway, a door to the rear which opens to a store room, a window to the side aspect and a door also to the side aspect which opens to the garden.

Front

Having a tarmac driveway suitable for parking multiple vehicles, a lawn, security lighting, various plants, shrubs and bushes and access to the garage

Rear

Having a patio dining area, steps up to a lawn which is retained by sleepers, a water-feature (not included in sale) a cold-water tap and various plants, bushes and shrubs.









* A large, three bedroom, bungalow located in a desirable area *

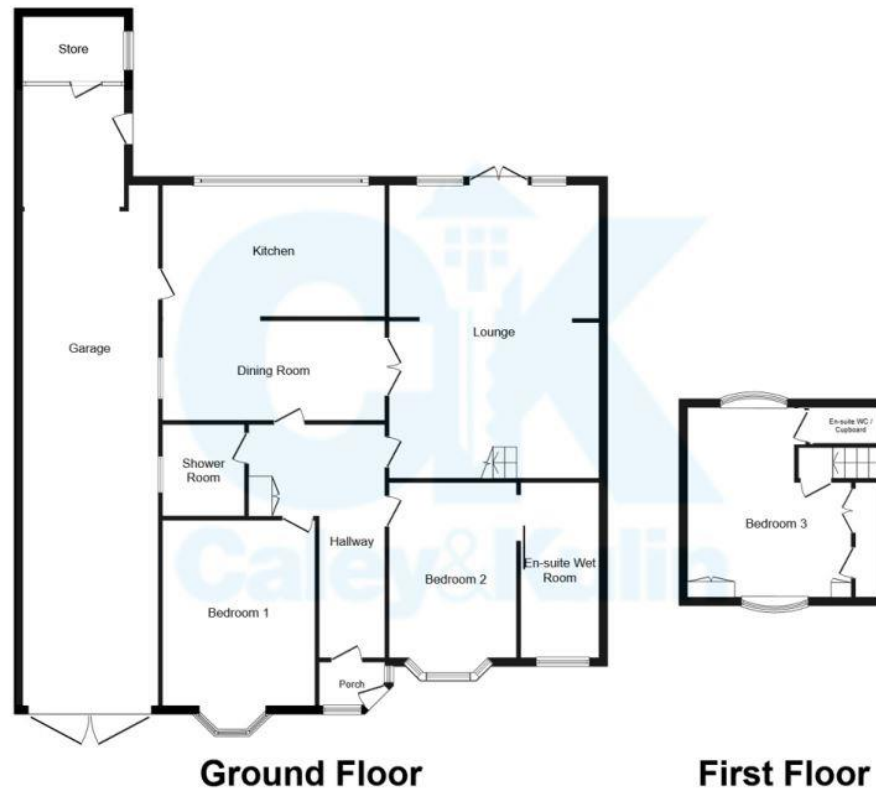

This plan is for illustration purposes only and may not be representative of the property. Plan not to scale. Powered by PropertyBox

To view this property please contact Caley & Kulin on:

Cannock: 01543 396880 **Stafford:** 01785 559880

Wolverhampton: 01902 953923

E-mail: info@candk.co.uk

Staffordshire House, Clay Street, Penkridge, Stafford, ST19 5AF

View this property online candk.co.uk

Council Tax Band: E

EPC Rating: E

Tenure: Freehold

Version: CK1266/001



Find us on facebook

facebook.com/candk.co.uk



These particulars are not to form part of a Sale Contract owing to the possibility of errors and/or omissions. Prospective purchasers should therefore satisfy themselves by inspection or otherwise as to their correctness. All fixtures, fittings, chattels and other items not mentioned are specifically excluded unless otherwise agreed within the Sale Contract documentaries or left in situ and gratis upon completion. The property is also sold subject to rights of way, public footpaths, easements, wayleaves, covenants and any other matters which may affect the legal title. The Agent has not formally verified the property's structural integrity, ownership, tenure, acreages, estimated square footage, planning/building regulations status or the availability/operation of services and/or appliances. Therefore prospective purchasers are advised to seek validation of all the above matters prior to expressing any formal intent to purchase.

See all our properties at www.candk.co.uk | www.rightmove.co.uk

